

EA-225

Professional Grade Hybrid In-Ear Monitors

EA-225 professional-grade in-ear hoop earphones use hybrid driver units to deliver detailed and full sound and powerful bass. The cavity model is shaped based on big data's auricle design, and is paired with a variety of comfortable sound-isolating earphone sleeve and detachable earphone cables to provide delicate and rich sound effects without being affected by external noise. Allowing you to enjoy a high-quality listening experience whether on stage or on the street.

Specifications

Product model:	EA-225
Wear:	Ear hook
Frequency response:	20Hz-20000Hz
Jack type:	3.5mm
Earphone topography:	Hybrid In-Ear Monitors
Connector type:	2 pin
Impedence:	22Ω
Sensitivity:	107dB
Weight:	Earpiece+Cable: 9.2g+13g
Cable length:	1.25m±5cm
Colours:	Transparent

Installation/detachment of earphone cables

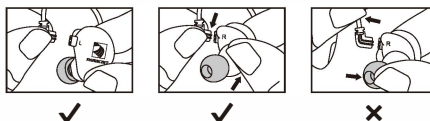

You may need to detach the cable from the earphones to attach optional components or to replace the cable if it becomes damaged. To prevent accidental separation, the connector has a snag fit. Take special care to prevent damage to the earphone and connector.

- Do not use pliers or other tools.
- Grasp the connector and the earphone as close as possible to where they join.
- Pull straight apart—do not twist. Cable is a snap fit, not threaded.
- Do not pull on the cable or put any pressure on the earphone nozzle.
- When reattaching the cable, match the "L" and "R" markings.



Select/replace earphone sleeve

The random list of in-ear headphones includes several different sizes of earphone sleeve. By default, the M model silicone ear sleeves are installed on delivery. Choose an earphone sleeve that best suits you for comfort, good fit, effective blocking of external noise and the best possible sound.

 Silicone earphone	In small, medium, and large sizes.
 Memory foam earphone	In small, medium, and large sizes. Compress the foam sleeve between your fingers and insert into the ear canal. Hold in place for about ten seconds while the foam expands.

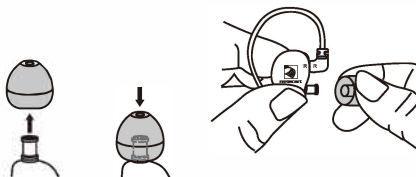

Note: If the nozzle is exposed, the sleeve is not properly installed. Replace sleeves if they do not tightly grip the nozzle. To ensure proper fit and performance, use only sleeves supplied by Relacart (unless using custom molded sleeves).

Wearing the Earphones

Insert the two earphones into the left and right ear as indicated. And carefully insert the earphone into the ear like an earplug, so that a tight seal is formed.

Important: If there is a lack of low frequency response (bass), the earphone sleeve may not be forming a proper seal. Please gently push the earphone deeper into the ear canal or try using a different sleeve (Memory foam earphone sleeve are easier to fit into the ear canal).

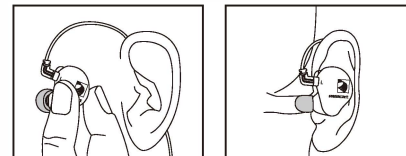

The fit of the earphone can greatly affect sound quality.

Warning: Do not push the earphone sleeve beyond the ear canal opening.

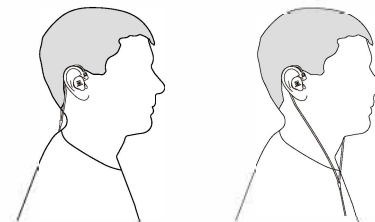

Wear the cable over the ear and secure it behind the head to help keep the earphones in place during physical activity.

Note: 1. Make sure that the earphones fit, are comfortable and secure.
2. Do not pull on cable to remove earphone.

Maintenance

- To clean all parts of the in-ear headphones, use a soft cloth moistened with an alcohol cleaner. Make sure that no liquid penetrates the housing or flows into the transducer.
- Do not use solvent-based rags to clean the device, as this may damage the device.
- The earwax protective net can only be put back into the sound guide hole after it is clean and dry.
- We recommend that the earphone sleeve be replaced regularly, every 3 months.