



UR-280

Dual Channel Diversity Wireless Microphone

A decorative graphic consisting of numerous thin, overlapping blue lines that create a sense of motion and depth, resembling a stylized wave or sound wave. The lines are more densely packed in some areas, creating darker shades of blue, and more sparse in others, creating lighter shades.

Quick Use Guide

UR-280 Wireless Receiver

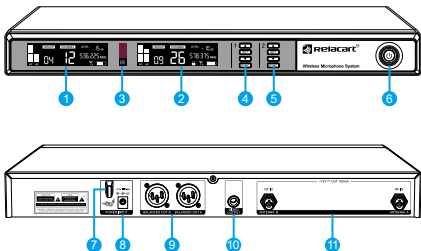

- | | |
|----------------------|------------------------------------|
| 1 CH1 Display | 7 Anti cable-pulling loop |
| 2 CH2 Display | 8 DC power input socket |
| 3 iR Sync window | 9 Audio output (balanced) |
| 4 CH1 Control button | 10 Mixed audio output (unbalanced) |
| 5 CH2 Control button | 11 BNC antenna input port |
| 6 Power switch | |

UH-280 Wireless Handheld Microphone

- 1 Microphone pickup module
- 2 Display
- 3 Microphone handle
- 4 iR Sync window
- 5 Select button
- 6 Set button
- 7 Battery compartment
- 8 Charging contacts
- 9 Power switch

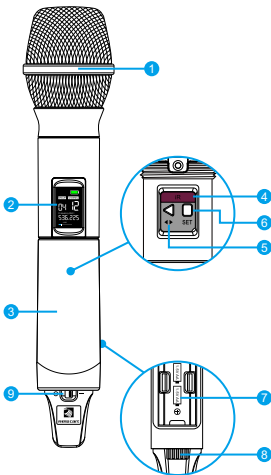

UT-280 Wireless Bodypack Microphone

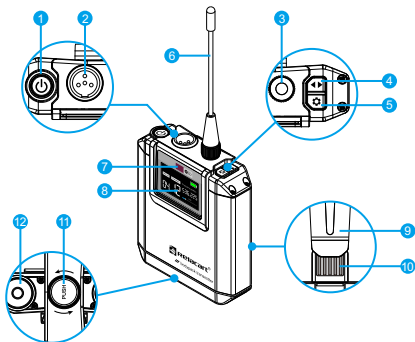

- 1 Power switch
- 2 Audio input socket
- 3 Antenna output socket (SMA)
- 4 Select button
- 5 Set button
- 6 TX antenna
- 7 iR Sync window
- 8 Display
- 9 Clamp
- 10 Charging contacts
- 11 Battery switch
- 12 Battery compartment

BNC Wireless Installation

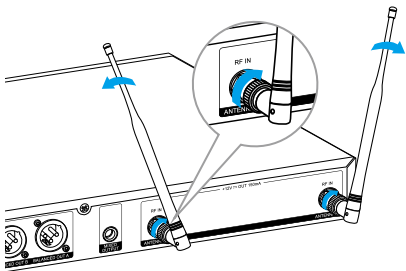
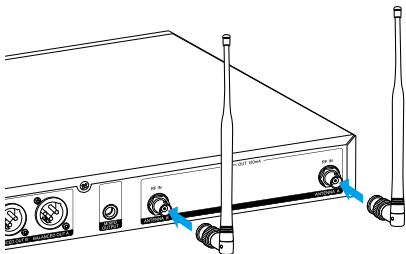

Connect the Power Adapter

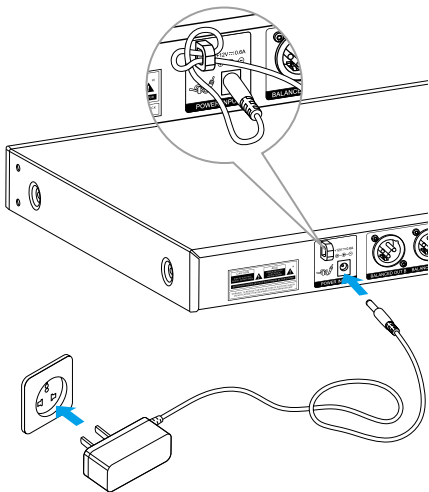

Use a power adapter that complies with local regulations

Connect the Audio Output

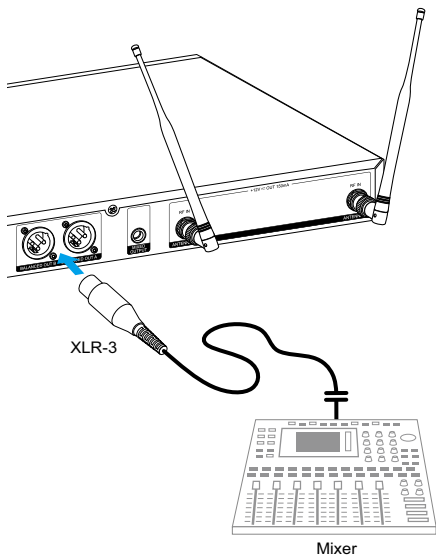

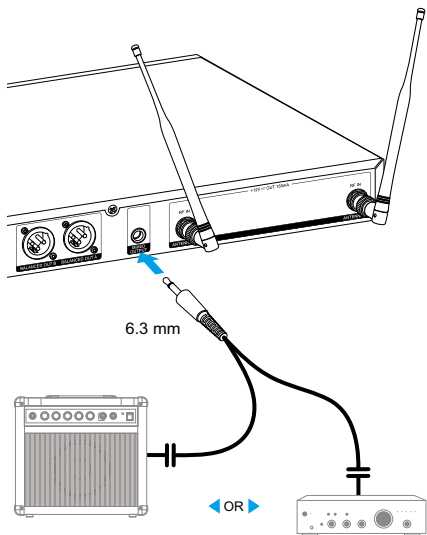

Transmitter Battery Installation

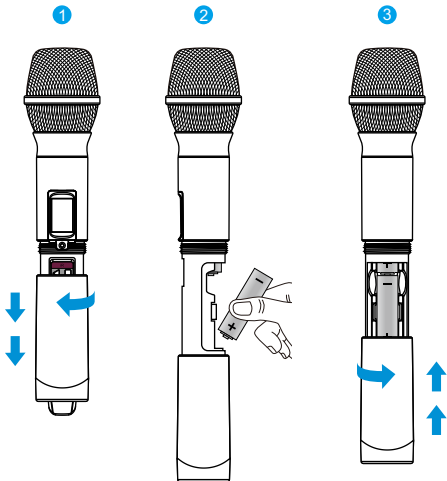

AA battery*2 pcs
(Note the polarity marks)

- 1 Press "PUSH" while turning the battery door counterclockwise

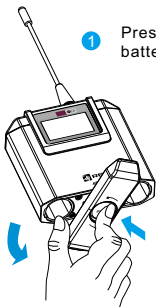

3

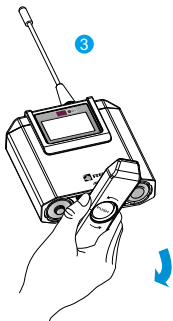

2

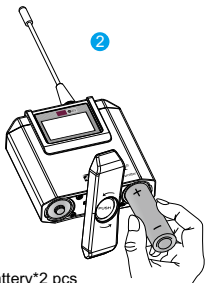

AA battery*2 pcs
(Note the polarity marks)

Display

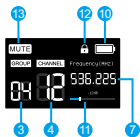
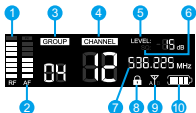

- 1 RF signal
- 2 Audio output signal
- 3 Frequency group
- 4 Channel
- 5 Volume level
- 6 RF squelch threshold
- 7 Frequency

- 8 Receiver keyboard lock
- 9 RF antenna status
- 10 Battery level
- 11 Input gain
- 12 Transmitter keyboard lock
- 13 Mute mode

Operation Menu

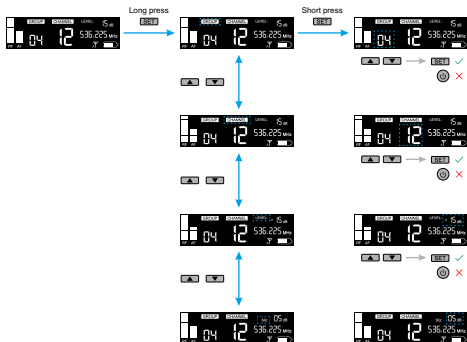
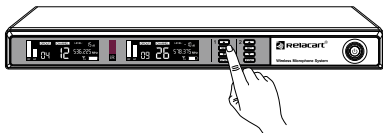

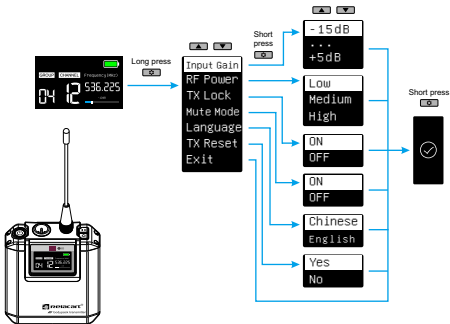
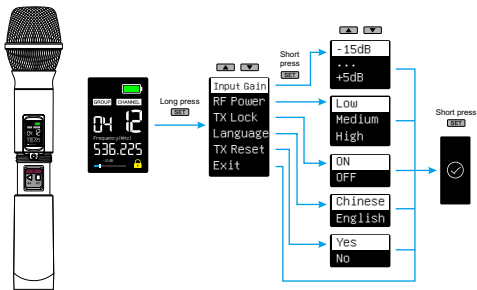

ON/OFF

UR-280



Short press [ON]
Long press [OFF]

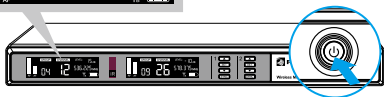

UH-280

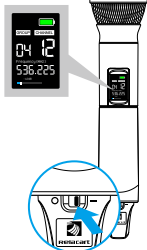

Short press [ON]
Long press [OFF]



OFF ↔ ON

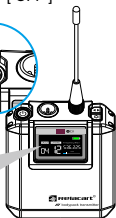

UT-280

AFS Automatic Frequency Search

Long press [▲]

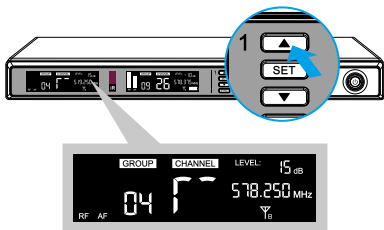

When searching for a channel, the frequency changes simultaneously according to the channel.

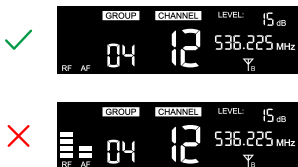

0 grid on the RF indicates the frequency is clean.
If not, please repeat this operation.

SYNC Frequency Synchronization

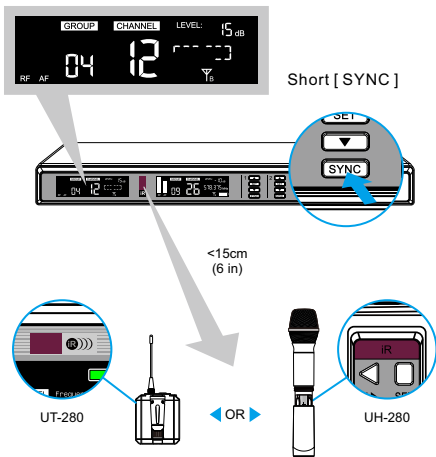

Note: When iR infrared binding, the handle of the handheld microphone must be unscrewed. Otherwise, the binding function will be affected.



UT-280



UH-280

Both receiver and transmitter display are in the same frequency

The usage of the transmitter

UH-280

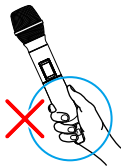
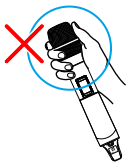
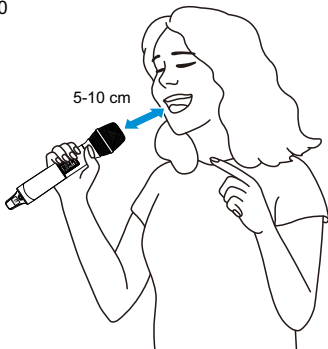

UT-280

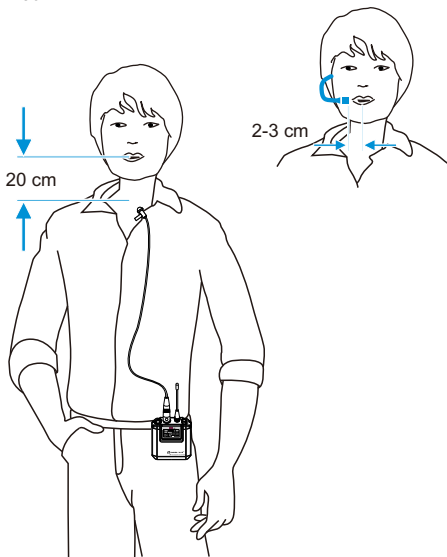



www.relacart.com



[Learn more](#)



[Product specification](#)